

160MM X 32MM

**Verticaal instellen - Set vertically - Vertikal einstellen**  
 Installation verticalement

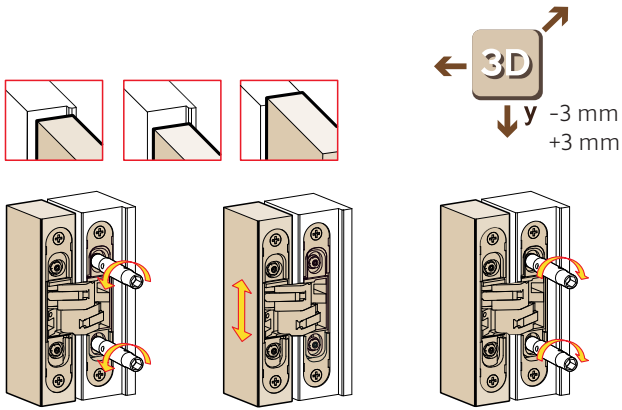

**Horizontaal instellen - Set horizontally - Horizontal einstellen**  
 Installation horizontalement

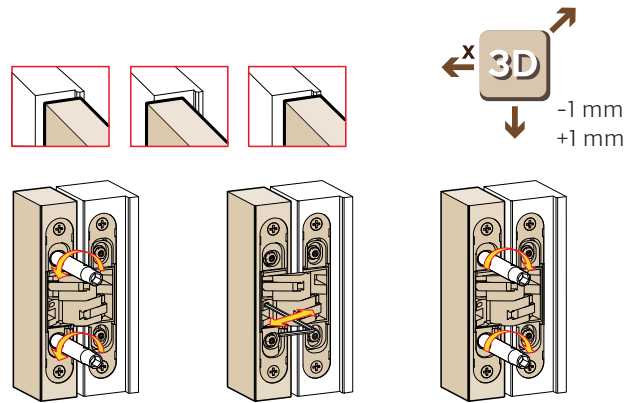

**Diepte instellen - Set depth - Tiefe einstellen**  
 Définir la profondeur

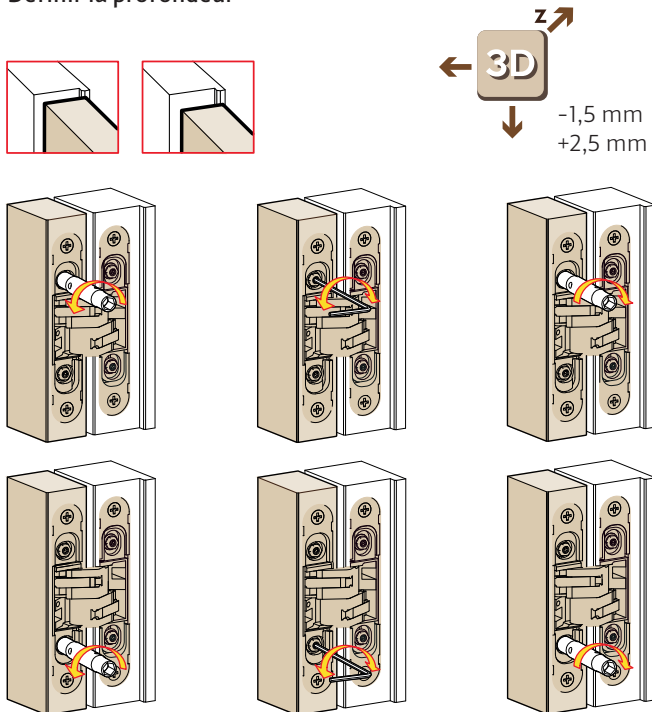

**Extra diepte instellen - Set additional depth - Zusätzliche Tiefe einstellen**  
 Définir une profondeur supplémentaire

